

NSM – New Hospital Campus Malmö

EuHPN Study tour, 29 Mars 2023



Illustration: White arkitekter



This is Region Skåne

**Our mission is to promote health,
sustainability and growth in Skåne.**

Responsible for:

- healthcare
- public transport
- development of trade and industry,
culture, infrastructure, social planning
and environmental and climate issues



NSM – New Hospital Campus Malmö

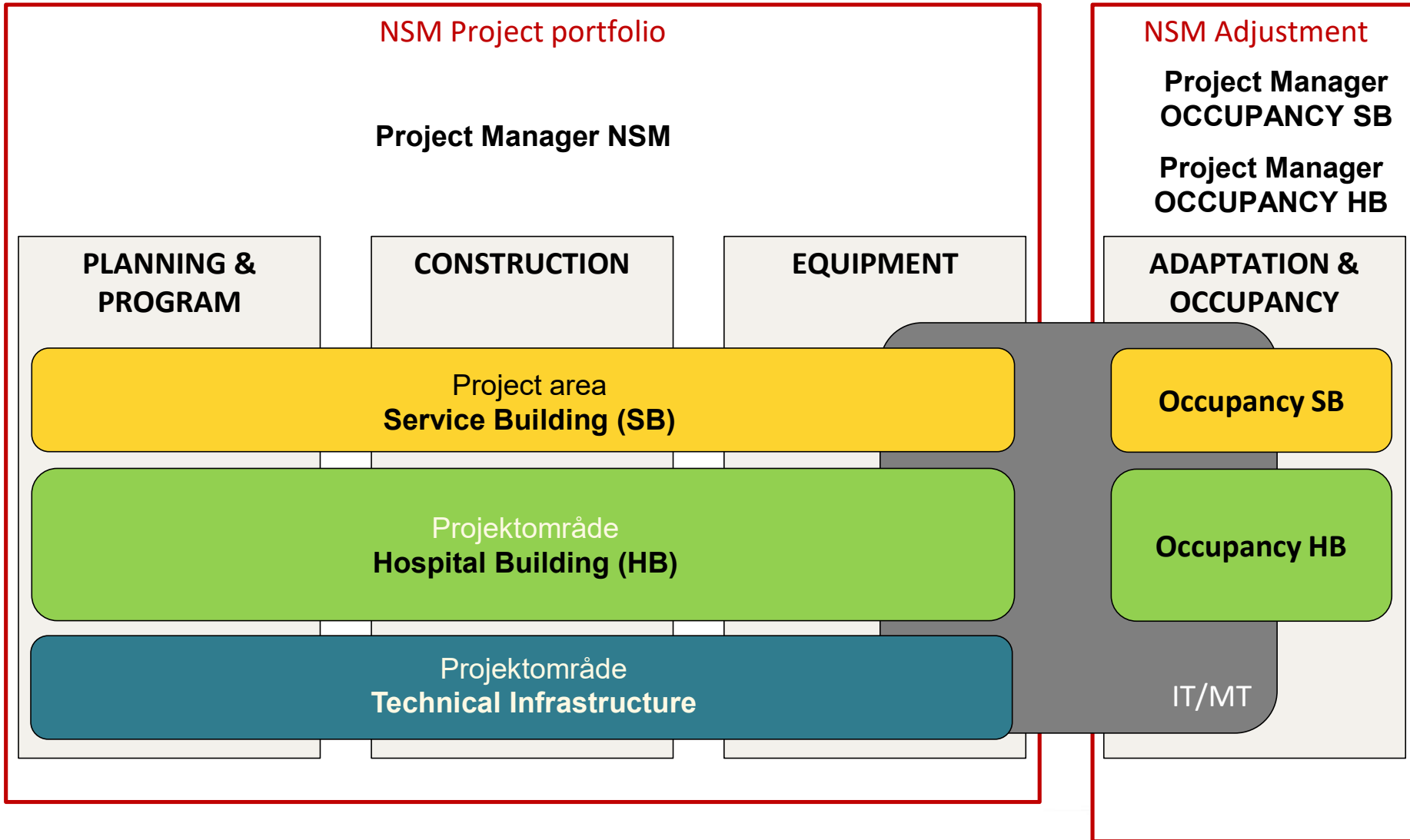

Why build a new hospital in Malmö?

Photo: Perry Nordeng



An integral part of Malmö

A centrally located hospital with adequate transport connections makes life easier for patients, their relatives and those who work at Skåne University Hospital.

A hospital in the heart of the city contributes to world-class quality of life.

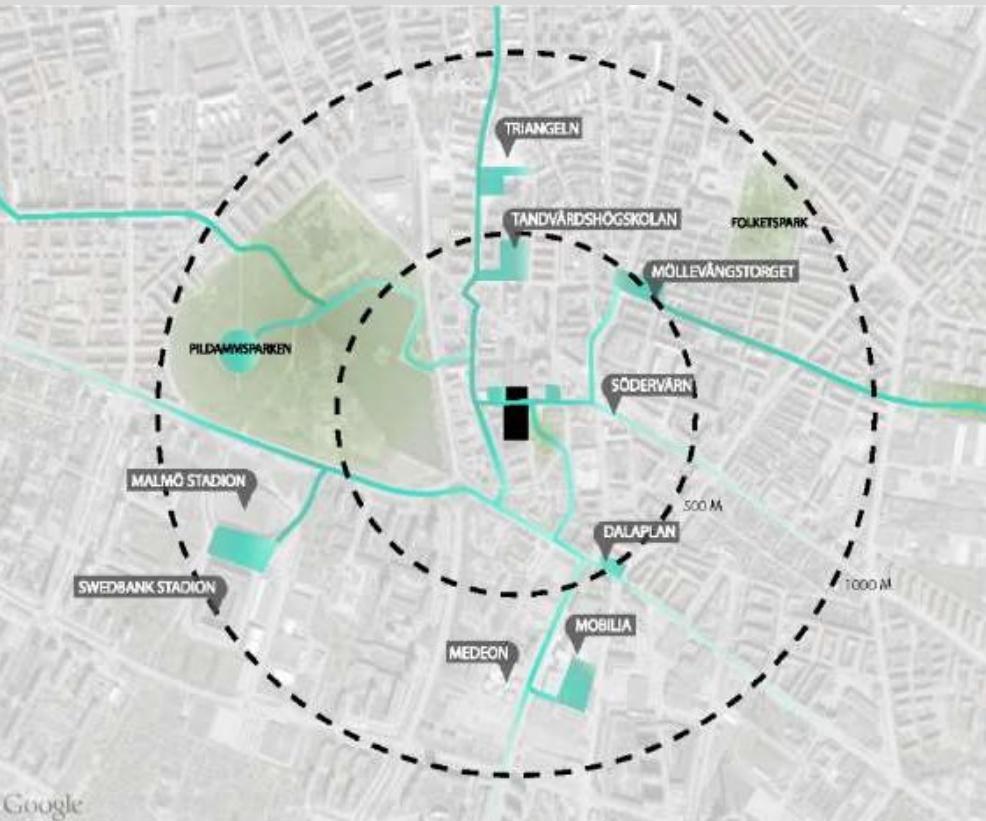

Google

Illustration: White arkitekter



New scope and revised budget

A decision made in December 2013 regarding the investment framework for the project entailed both the demolition and new construction of buildings.

However, during the course of the project, it has become apparent that the requirements are greater than originally estimated:

- The hospital building has increased in scope from approximately 65,000 m² to over 100,000 m²
- The service building has increased from approximately 15,000 m² to 25,000 m²
- There is also a greater need for investment in technological infrastructure

The revised calculations resulted in a new scope for the NSM project and a new investment budget, which was approved by the Regional Council in June 2017.

A selection of our impact goals

- Single rooms for patients provide an opportunity for increased patient safety
- Creation of a cohesive patient flow by locating relevant departments and services in the same building
- Improved possibilities for quick acute diagnostics through open and flexible laboratory premises
- New waste centre creates better conditions for managing the waste created from hospital activities
- New premises are facilitators for learning, research, education and training

Governing planning principles

The Patient Safety principle

This is the single most important factor to be evaluated in the event of conflict with other principles

- Minimise healthcare injury and the spread of infection
- The right competence in the right place at the right time



The Sustainability principle

- Attractive, safe and healing environment
- Plan for economic, ecological and social sustainability
- Long-term useful buildings – generality, flexibility, elasticity



The Flow principle

- Optimise the patient's journey throughout the entire care process
- Separate public and non-public flows
- Easy to find and orientate oneself



The Knowledge and Development principle

- Integrate healthcare, education & training and research
- Facilitate collaboration with universities, colleges and trade & industry



The process of the healthcare services

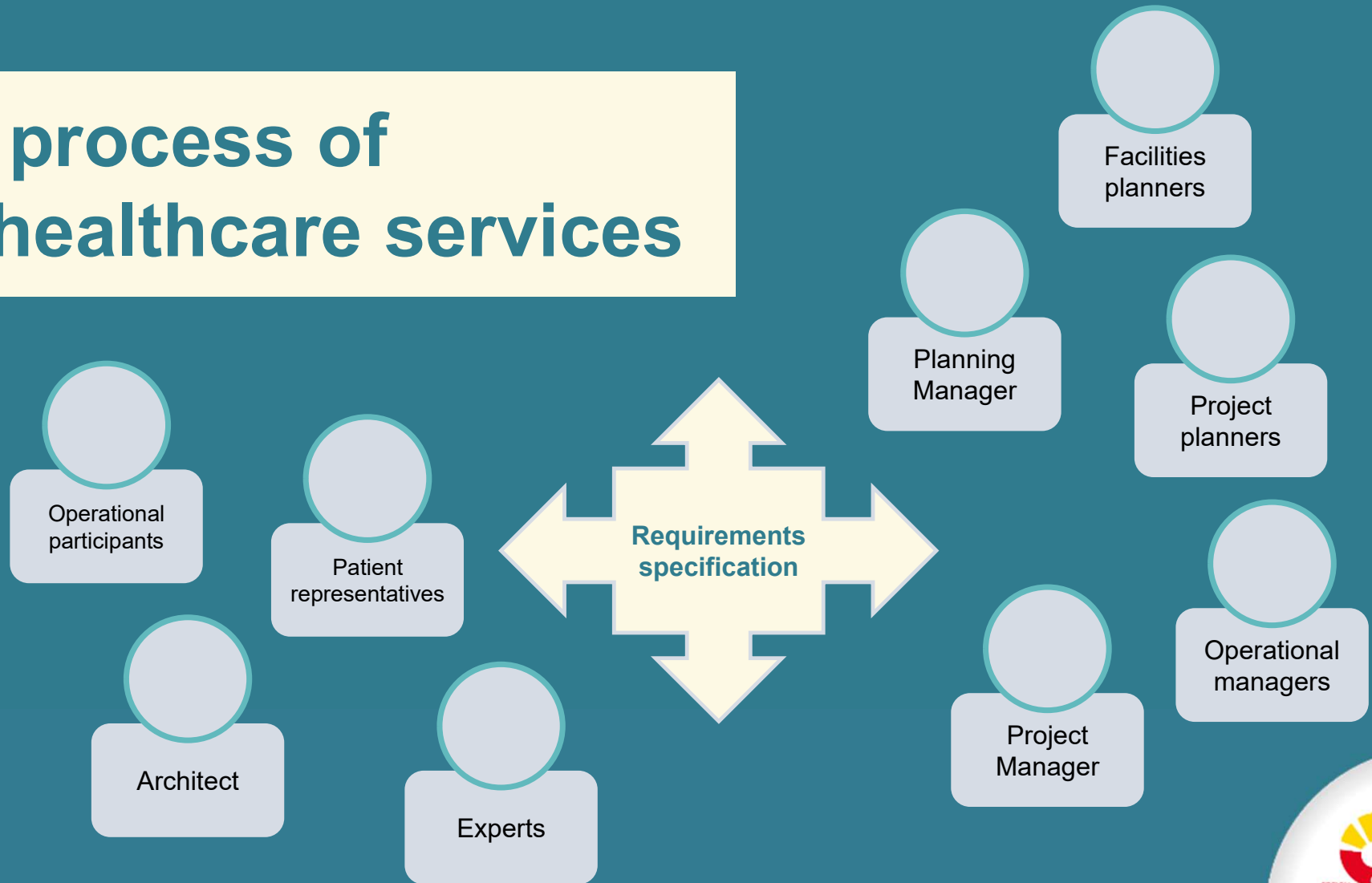

Hospital floor plan

- Inpatient ward
- Treatment/Medical service
- Outpatient clinic
- Other service/Training
- Supply
- Administration
- Technology

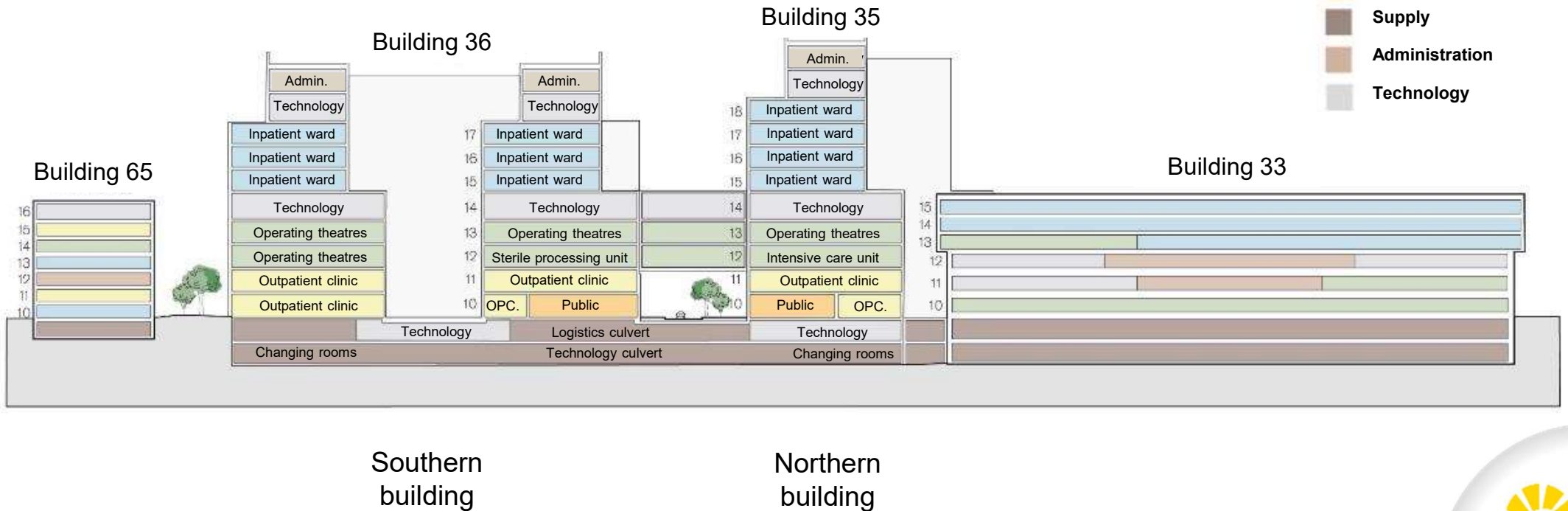

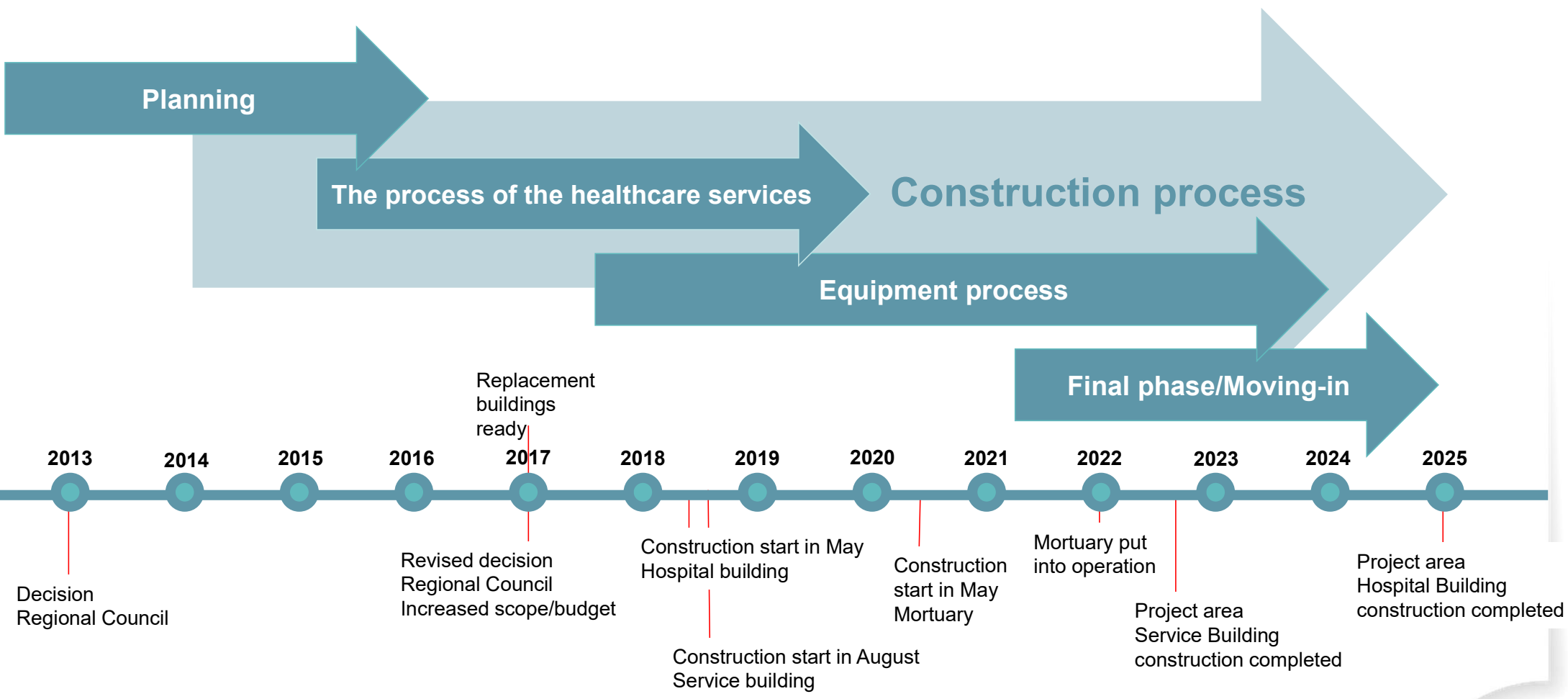

Project NSM – New Hospital Campus Malmö



The process of adjusting to the new hospital building

- Development of new working methods at the different healthcare departments
- Preparation for moving in
- Education and way finding
- Final preparation of the premises
- Final preparation of equipment
- Moving in
- Follow-up

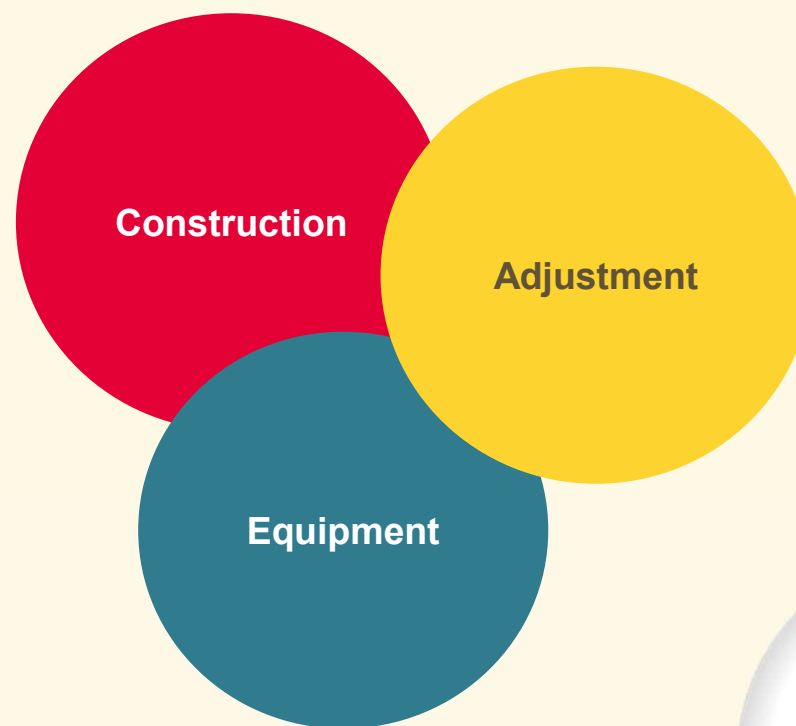

Our scope

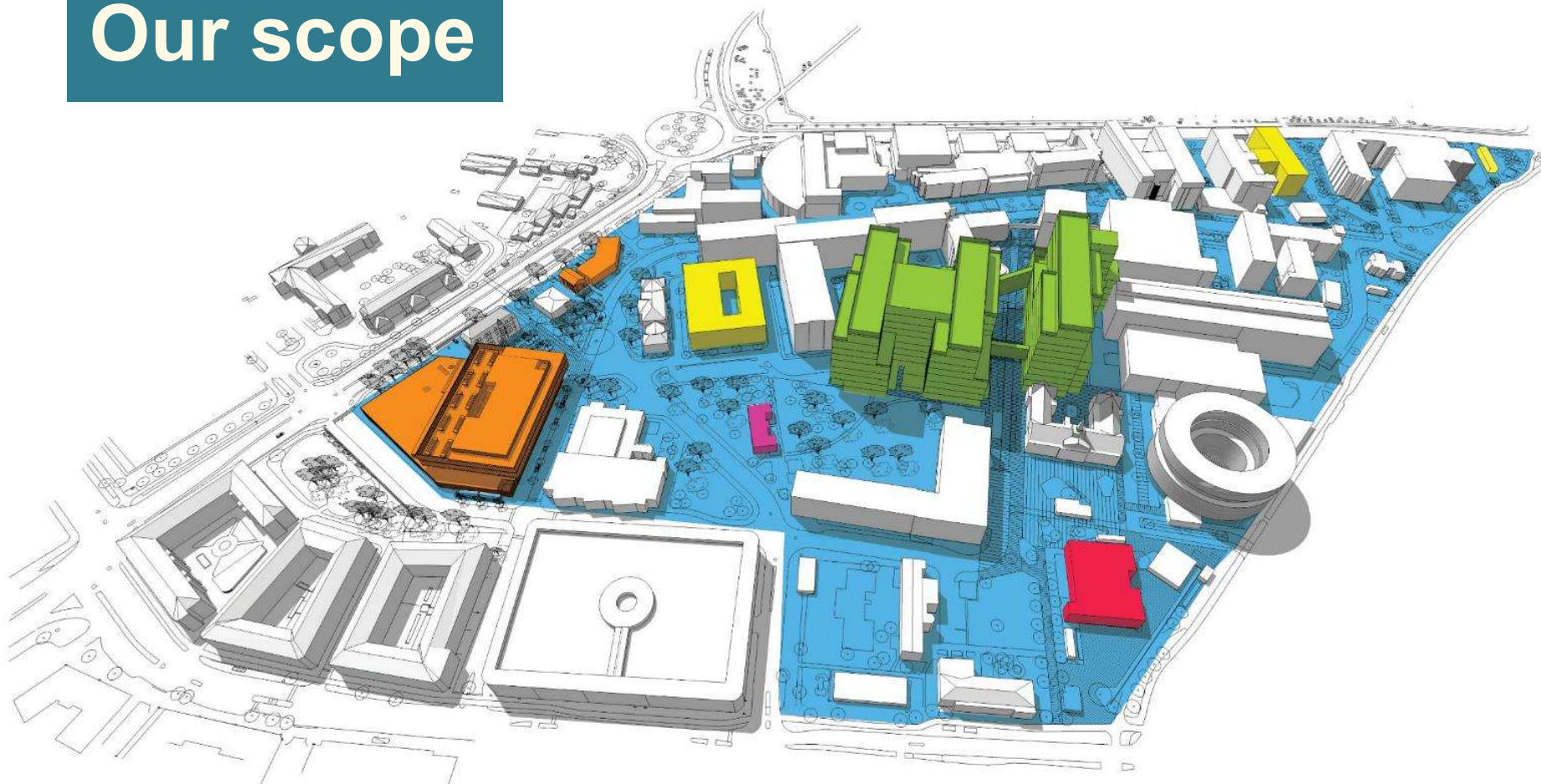

Illustration: White arkitekter

Replacement buildings

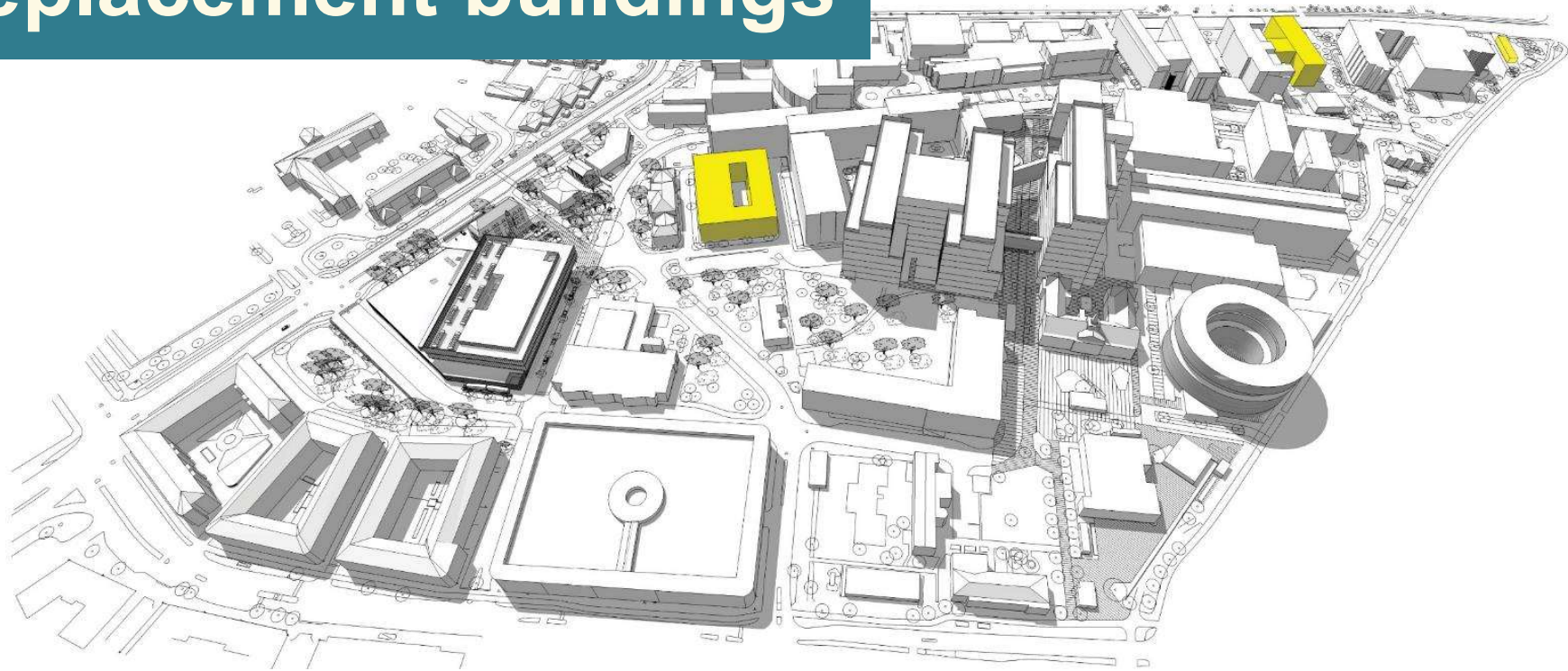

Illustration: White arkitekter



Project area

Hospital Buildings

Photo: Perry Nordeng



The hospital buildings

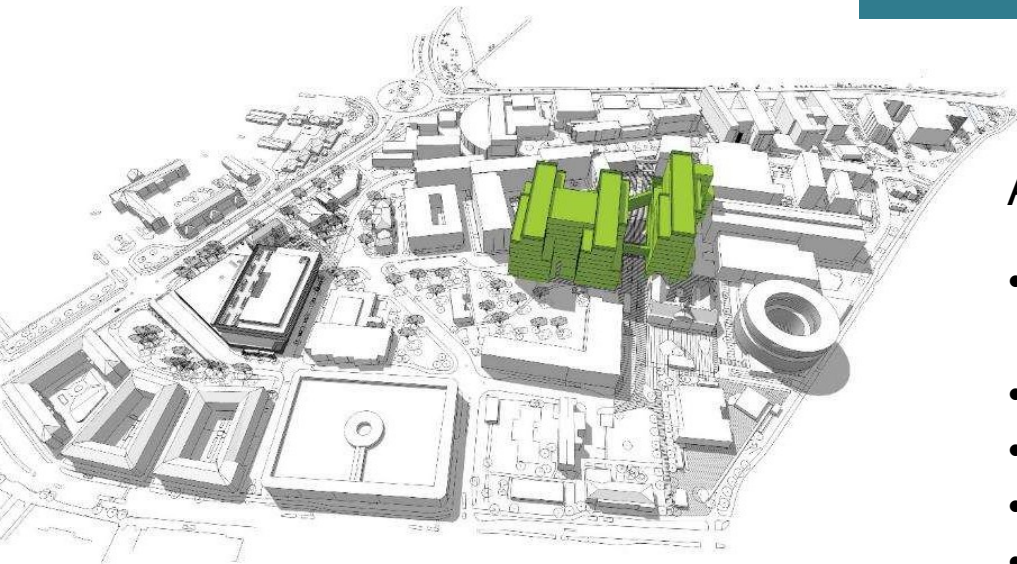

Approx. 108,000 m²

- two separate but connected buildings, one with ten floors and the other with eleven floors
- 10 hospital wards
- 240 single rooms for patients
- 23 operating theatres
- outpatient and day care units
- admission ward for planned surgery
- intensive care unit with designated beds for children

Skanska is the general contractor for the hospital building. The northern part is planned for completion in December 2023, and the southern part in 2025. Installation and moving-in will commence thereafter.

Project area

Service Buildings



The service building

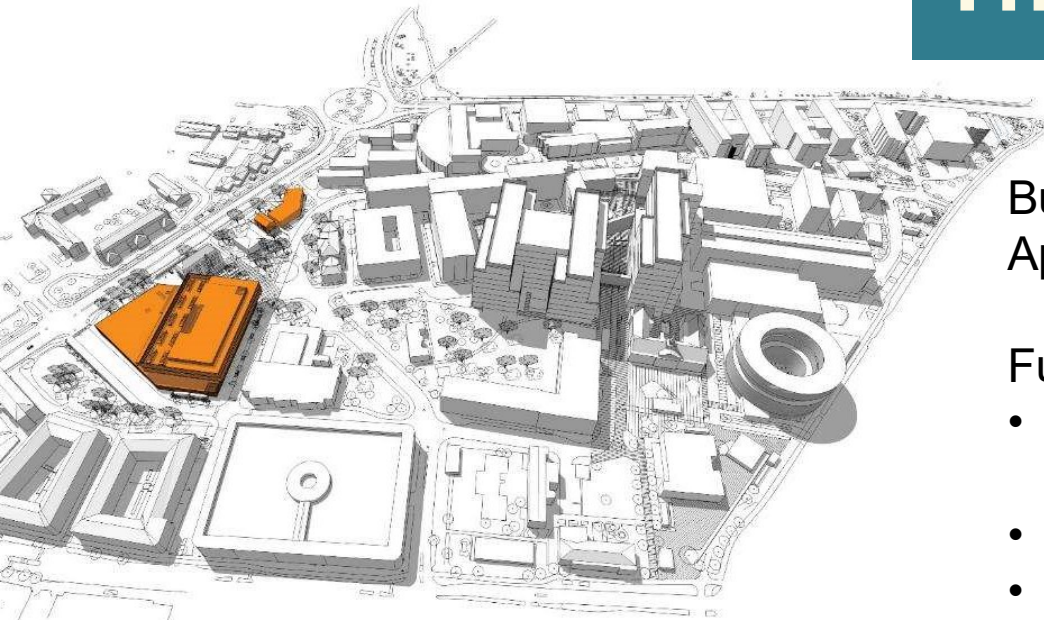

Building completion: June 2022.
Approx. 27,000 m²

Functions that will be housed in this building:

- clinical laboratory with around-the-clock analysis of samples and test results
- pharmaceutical supply
- hospital joint technology
- receipt of goods deliveries
- receipt of meal deliveries
- waste management
- postal services
- educational and administrative premises

Illustration: White arkitekter

The mortuary



Photo: MadsFrederik



Project area

Technical Infrastructure

The infrastructure of the hospital

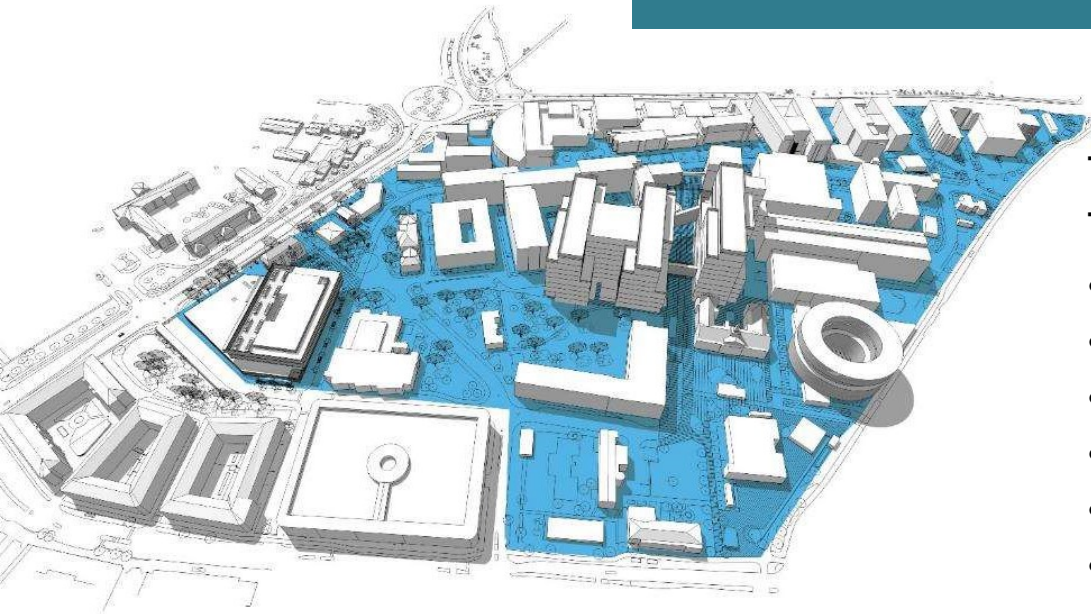

The following projects exist within the project area
Technical Infrastructure:

- AGVs (automated guided vehicles)
- pneumatic tube postal system
- power system
- telecoms/IT
- special water
- medical gases
- sprinklers

Illustration: White arkitekter

Automated vehicles

The automated guided vehicles (AGVs) contribute to more sustainable and efficient deliveries and returns of e.g. food and laundry within the various operational departments at the hospital campus.

In the new buildings on the hospital campus, the AGVs will automatically drive all the way up to and will make deliveries directly to each floor.



Pneumatic tube postal system

A new hospital-wide pneumatic tube postal system will be built, and the departments that need to be able to receive and send items via the pneumatic tube system will have access to it after the redevelopment work. The pneumatic tube postal system is used for sending and receiving test samples, blood bags and pharmaceuticals.

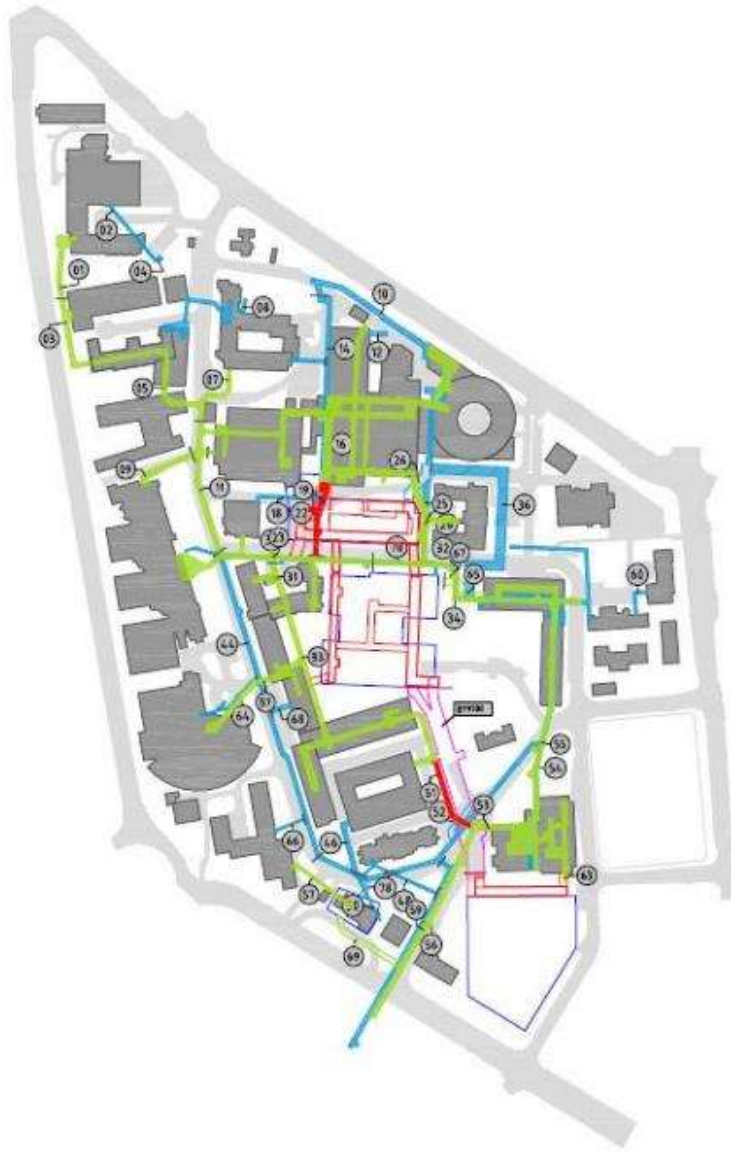

Culvert system

Comprehensive redevelopments and extensions have been made to the culvert system to be able to build the hospital and service buildings.

Among other things, a 150-metre-long and 13-metre-wide culvert (for both technology and transportation) has been built to connect the new buildings.



"Train of thoughts", Caroline Falkholt, 2017. Photo: Wanås Konst.

Art – a 2024 perspective

Within the framework for the project, artistic expression from a 2024 perspective will be an important element of the hospital campus and adjacent urban environments and recreational areas.

The location-specific artistic works will contribute to (among other things):

- The character of the area
- Ease of orientation
- Making unexpected contact areas visible
- Communicating messages from surprising viewpoints



Healing environments – both inside and out

Artistic expression (among other things) is an important part of the work aimed at creating healing environments, both inside and out.

Green areas enhance a sense of wellbeing, reduce stress and have a pain-easing effect. Feeling close to nature can also hasten the recovery of patients and improve the experience of their hospital stay.

Our challenges

- **large scale**
- **complicated**
- **complex**



Please follow us on social media.

 **LinkedIn**

Region Skåne – utveckling & innovation

 **Instagram**

nyasjukhusomradetmalmonsm



An aerial photograph of a city, likely Malmö, Sweden. The image shows a dense urban area with various buildings, including a large stadium with a blue roof in the upper left. A large, dark lake is situated in the upper right, surrounded by trees. The word "Questions?" is overlaid in a teal box on the left side of the image.

Questions?

Photo: Perry Nordeng

