

Critical Care Complex Ulster Hospital Northern Ireland

Critical Care
State-of-the-art clinical facilities



Health Facility Project Name	Critical Care Complex, Ulster Hospital
Country	Northern Ireland, UK
Location	Ulster Hospital, Dundonald, Belfast, Northern Ireland, BT16 1RH
Population served	South Eastern HSC Trust – 440,000 Ulster Hospital – 270,000
Type of healthcare facility	Extension to Acute Hospital
Type of construction	New build
Construction start date	31 March 2007
Construction completion date	28 April 2010
Gross floor area	16,162 m ²
Project, design and construction cost	GBP 39,399,180
Cost per m²	GBP 2,438
Total bed numbers	16 bed intensive care unit 7 theatres 14 recovery
Departmental information	<ul style="list-style-type: none"> ▪ CSSD ▪ This highly automated state of the art facility is the most advanced sterile services department in Northern Ireland. This department provides decontamination services to all the South Eastern Trust and other Health Care Organisations. ▪ ▪ Levels 2 & 3 ▪ Theatre, Recovery and Intensive Care, Staff Changing and Administration. The 7 Modular operating theatres of which 2 are laminar flow have fully integrated Picture Archiving Communications systems and are equipped to the latest radiation and laser protection requirements. ▪ ▪ The 16 bed intensive care unit comprises of 4x2 bedded bays and 8 single rooms of which 3 have specialist isolation facilities (2 source isolation and 1 protective isolation).
Client/owner	South Eastern Health & Social Care Trust www.setrust.hscni.net

Capital procurement route	Public
Architects	Todd Architects www.toddarch.com
Contractor	Gilbert Ash
Project manager	Joe George Health Estates Investment Group (HEIG) Joe.george@dhsspsni.gov.uk
Services	Theatres Intensive Care CSSD Laboratories Endoscopy
Key facts	<p>The Critical Care Complex is one of the most technologically advanced health care buildings in the UK providing state of the art clinical and support facilities which will allow for future flexibility as services change and develop going forward.</p> <p>The interior of the building is designed to maximise natural light with spacious, comfortable and aesthetically pleasing surroundings. Particular attention has been given to creating an environment which is conducive to improving patient health, comfort and recovery. This is particularly evident in the choice of colours providing a therapeutic, healing and stimulating environment where appropriate. Privacy, dignity and respect for patients and their families was a key factor influencing the design, as was the desire to provide an environment that supported and enriched the daily working routine of the staff.</p> <p>Throughout the design process it was very much appreciated that both patients and relatives may be anxious and apprehensive when intensive care is required. To help alleviate this anxiety the design concept has focused on providing as far as is possible an environment which is 'non clinical' and offers areas for respite and relaxation including overnight accommodation for relatives of very ill patients.</p>









Ulster Hospital Critical Care Complex

Level 1 Plan



Ulster Hospital Critical Care Complex

Level 2 Plan

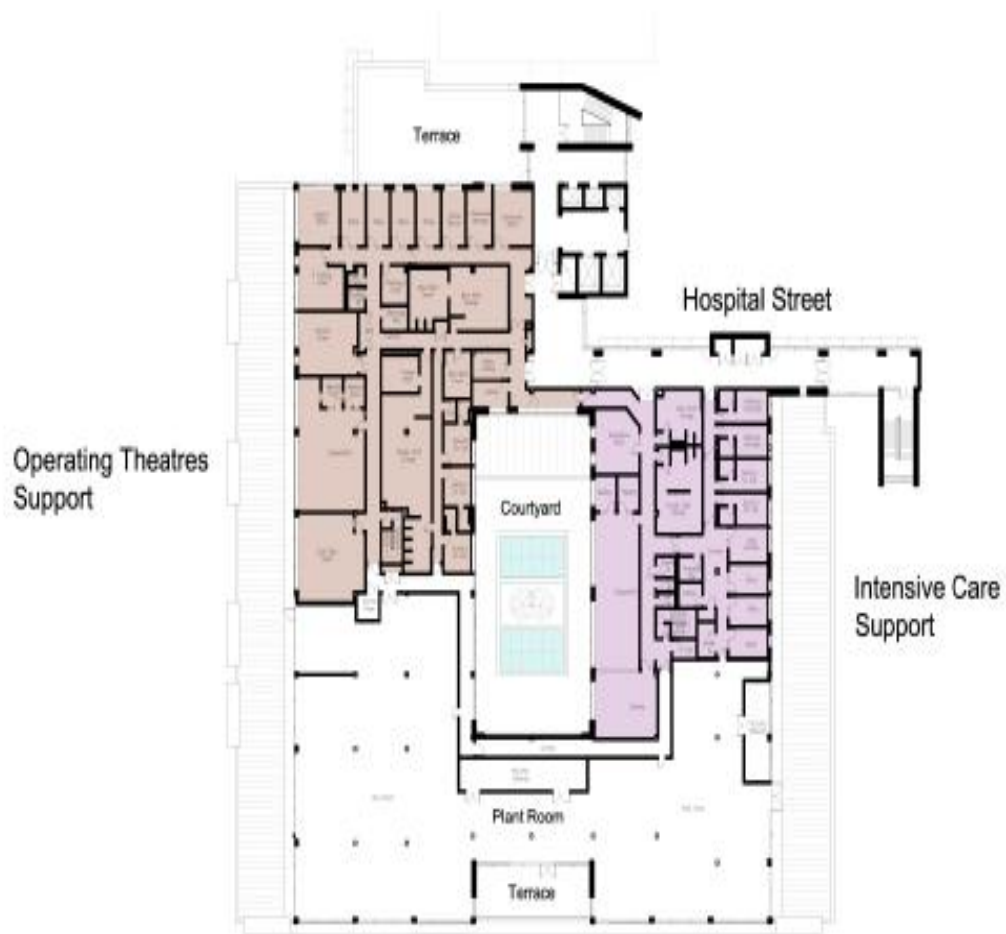

Ulster Hospital Critical Care Complex

Level 3 Plan

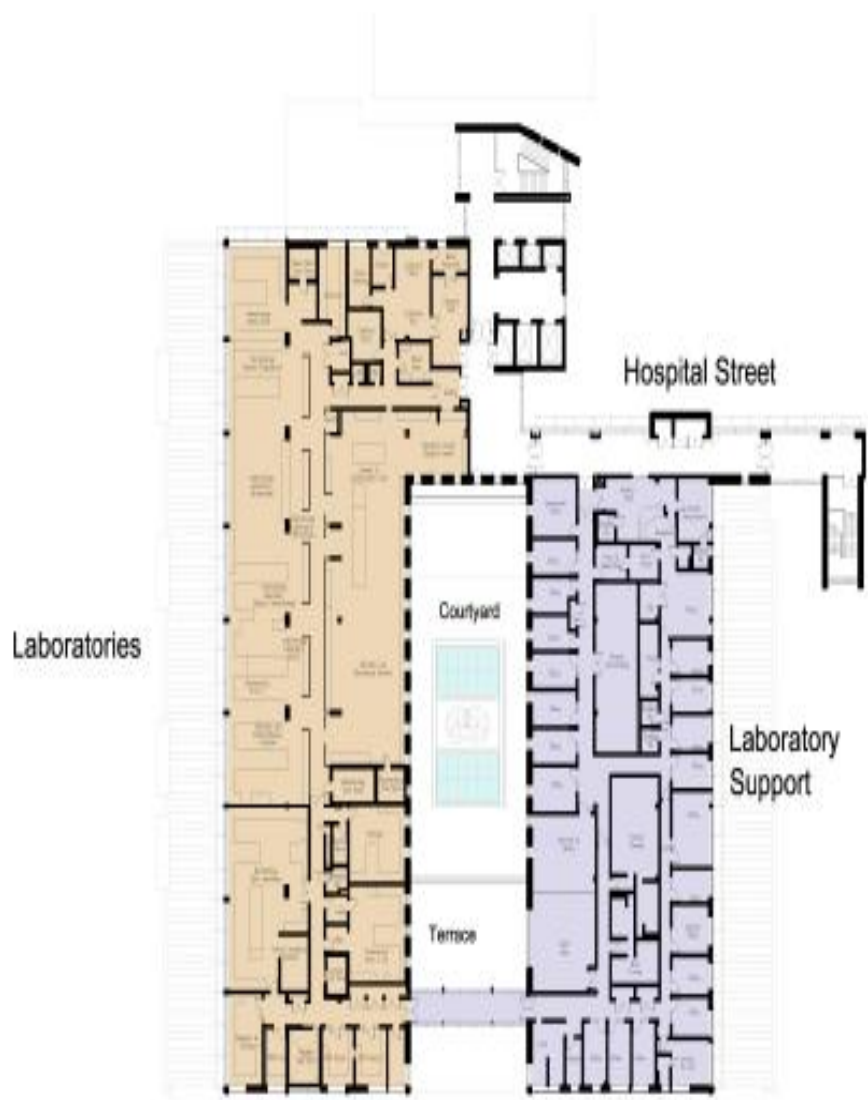

Ulster Hospital Critical Care Complex

Level 4 Plan